

FORM NO. 1.

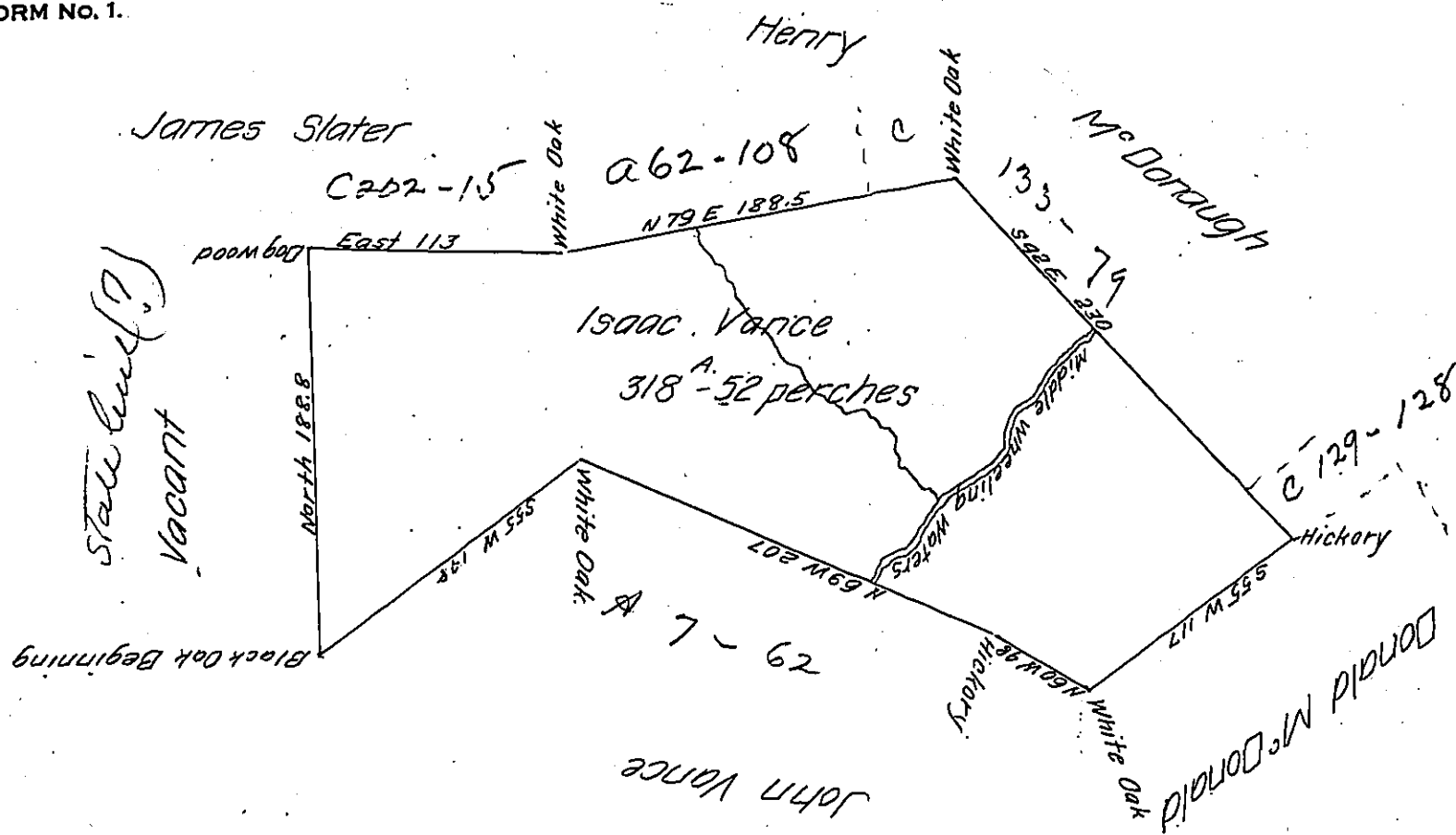

A Draught of a Tract of Land Surveyed the 10th day of June 1794 for Isaac Vance in pursuance of his Warrant for 318 ~~Acres~~ Acres dated the 10th day of February 1794 Situate on the Waters of Middle Wheeling Creek in Washington County Called Greenfield Containing three hundred eighteen Acres & fifty two perches together with the Usual allowance of 6 P Cent for Roads.

Signed

John Hoge, D.S.

By Virtue of a Warrant granted to Isaac Vance dated the 10th day of February 1794 the above described Tract of ^{Land} Containing three hundred eighteen Acres & fifty two perches & allowance of Six p. C. for Roads Situate on the Waters of Middle Wheeling Creek in Finley Township Washington County was Surveyed on the 10th day of June 1794, by John Hoge Esq. Late Deputy Surveyor And now examined ~~and~~ and certified to be correct this 2^d day of February 1802.

by,

To Samuel Cochran Esq.

Jonathan Leet, D.S.

Surveyor General of Pennsy.^a

Note: I find a Small Variation in two Lines of the above Tract & fifty two perches more in the quantity

J. Leet.

IN TESTIMONY that the above is a copy of the original remaining on file in the Department of Internal Affairs of Pennsylvania, made conformably to an Act of Assembly approved the 16th day of February 1833, I have hereunto set my hand and caused the Seal of said Department to be affixed at Harrisburg, this Sixth day of March 1907

Isaac P. Brown
Secretary of Internal Affairs.